



# HOSPITAL BED & STRECHER STORAGE



# Bed & Stretcher Storage Challenges



# Bed & Stretcher Lifts Provides A Solution

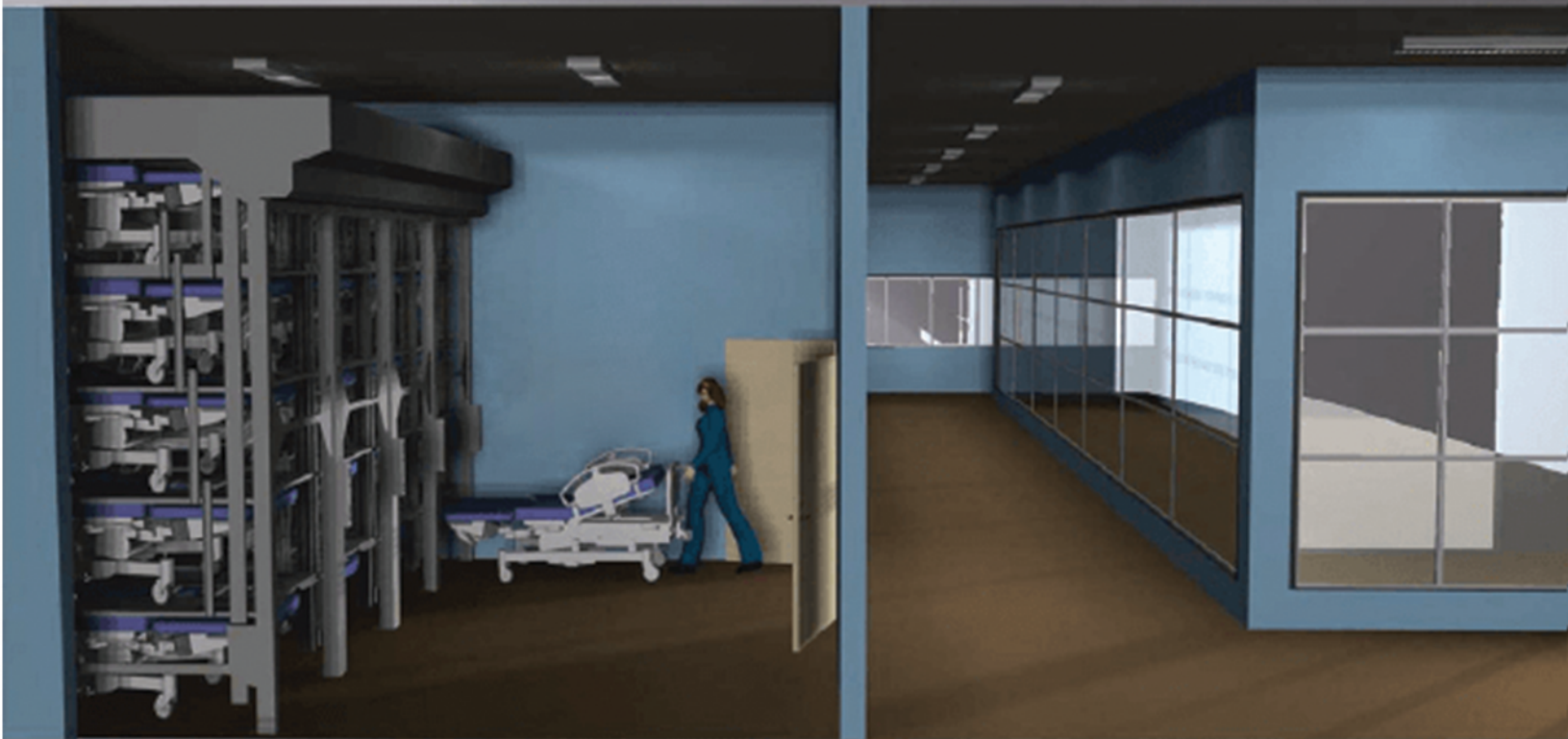

● ● ● ● ●  
SOUTHWEST**SOLUTIONS**GROUP

[www.SouthwestSolutions.com](http://www.SouthwestSolutions.com) | 800-803-1083



# Revitalize Your Space

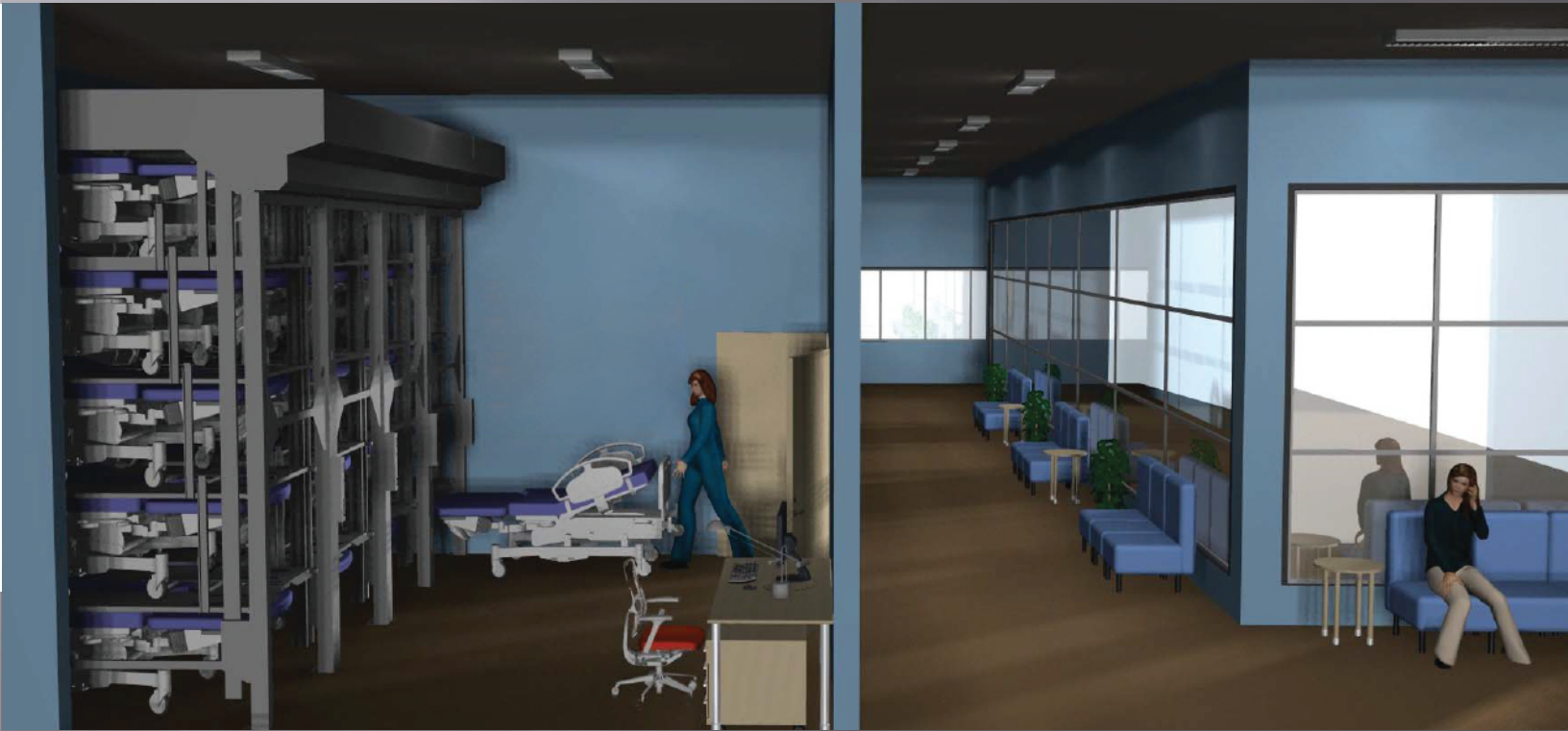

[www.SouthwestSolutions.com](http://www.SouthwestSolutions.com) | 800-803-1083



# BED LIFT: FUNCTION & VALUE

The Bed Lift stacks and stores hospital beds to:

- ▣ Save valuable floor and storage space.
- ▣ Secure and protect hospital beds.
- ▣ Reduce damage to beds in unprotected areas.
- ▣ Relocate beds from hospital aisles and floors to centralized storage
- ▣ Reduce fire hazards in hallways

That's function that fits...in tight spaces.



# BED STORAGE: BEFORE & AFTER



# BED LIFT: Information

## Come in 2, 3, 4 & 5 high with 27 inch and 33 inch net opening

Units are 4'5" wide, 10'0" deep at the top & 8'7" deep at base and range in heights from 7'4" to 12'3".

### Lead times:

Range from 6-8 weeks and from time to time we have units in stock for faster shipping.

### Color options:

Standard color scheme is white with grey accents [shown in renderings]. Units can be painted in any RAL color for a \$500 upcharge

### Electrical

Plug-and-play unit, provided correct electrical voltages are available  
Power runs from ceiling to the top control frame

### Install time

Approximately 4-8 hours per unit for two installers

### Freight

We handle all North American shipping—contact us for current rates

### Design/drawings

CAD blocks and drawing tools are available upon request

